

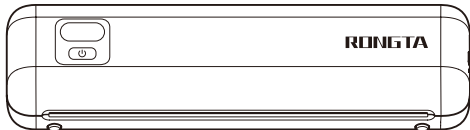

# Portable Thermal Printer

## Quick Installation Guide



Please keep this guide for your reference

# Thanks for choosing us!

## Customer Support

 Please kindly contact us if you have Any questions or concerns when installing and using.

 Email: [support@rongtatech.com](mailto:support@rongtatech.com)

 WhatsApp: +86 18150368963

Available time:

Mon-Fri 9AM-5PM (EST)

## Scan the below QR code to talk with us

### WhatsApp:



### Customer Support

Scan or upload this QR  
Code using the WhatsApp  
Camera to add us

## Extended Warranty

Please contact [support@rongtatech.com](mailto:support@rongtatech.com) to extend the warranty to 1 year with your order No.

## Accessories

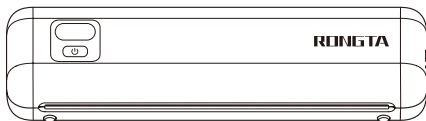

Printer



Quick Installation Guide

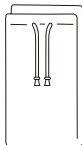

Flannel bag

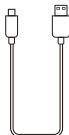

USB cable



Thermal Roll Paper



Type C adapter

**Note:** The picture of product, accessories and others in the manual are schematic, due to different versions, update or upgrade of product, There may be differences between the actual product and the diagram. Please refer to the actual product.

## Product Introduction

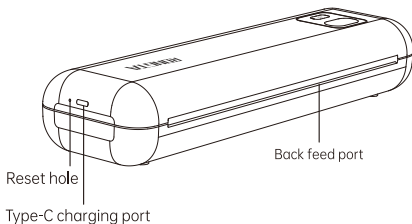
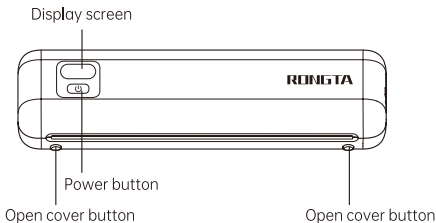

**Note:** Note: Press and hold the power button for 3 seconds to turn on the printer.  
In the startup state, long press the power button for 3 seconds to shut down.

## Roll thermal paper installation

### Reel mounting

#### (1) Open the top cover

Press the left and right cover buttons to open the top cover.

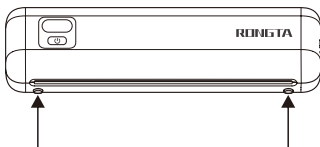

#### (2) Install the paper roll

Load the paper roll printing side up into the paper bin, adjust the paper width baffle according to the paper size, and install the paper roll backward. Move the lever above the paper width adjustment to lock the paper width adjustment block. Pull the paper to the edge of the printer near the outlet.



**Note:** The locking method for the paper width adjustment block is shown in the following picture!

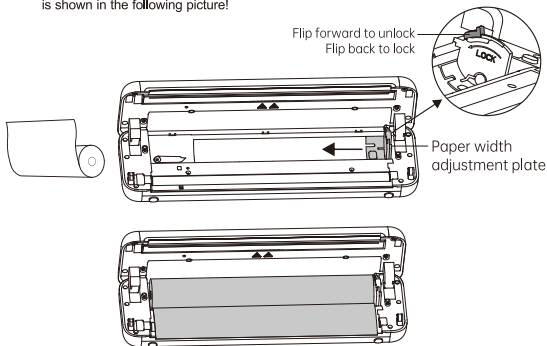

### (3) Close the upper cover

When the paper roll is installed, close the top cover. Make sure both sides of the top cover are stuck in place.

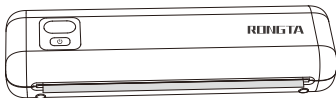

## Single Sheet & Continuous Thermal Paper Feeding

1. Prepare the thermal paper, identify the front side & back side:  
Front side is blank, back side have labels: Non-Printing Side.
2. Back side ( Non-printing side) should face up.
3. Feed the thermal paper: Hold the paper in both hand too keep it flat and straight, carefully insert the thermal paper into the printer's paper slot until the reel pull into the printing position.
4. Start the printing by smartphones(Bluetooth or WiFi) or Laptop(USB cable connection)
5. Remove the thermal paper: open the flip cover, take out the feeding thermal pape.

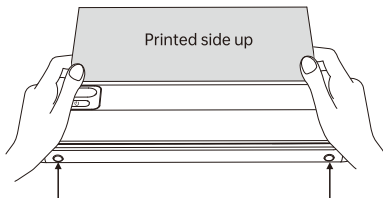

Press & Open top cover to remove the feeding thermal paper

- For best print results, use original paper.
- The short edge of the paper must be parallel to the feed slot.
- The paper can only be printed on one side. Check the paper and install it with the printing side facing upwards.
- When printing with a paper roll, after printing the document, peel off the paper along the paper knife.

# Mobile phone

## 1. APP download

Search and download "SoPrint" from Google Play or App store.



GET IT ON  
**Google Play**

Download on the  
**APP Store**

## 2. Connect the printer

(1) Open the APP, click "⊕" in the upper right corner, and the system will automatically search and display the printer name.

When the first time connection, there will be coming with "Connect via Bluetooth" or "Connect via Wi-Fi", please select the connection method according to the needs.

### Bluetooth connection

- ① Method 1: Turn on the Bluetooth of the mobile phone, Search device in the APP and connect (Select the model name of device) and choose connecting via Bluetooth; and select the Bluetooth connection;
- ② Method 2: Double-click the power button to print the two-dimensional code, click the scan code connection on the connected device page, and scan the two-dimensional code to connect the printer.

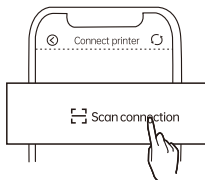
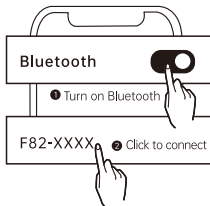



## WiFi connection

Turn on the Bluetooth of the mobile phone, turn to the connection interface after searching and connecting the device in the APP, and choose connecting via WiFi.

- 1 Enter the distribution network interface and select the Wi-Fi network for the printer.
- 2 On the WiFi distribution network interface, enter the WiFi password and click OK.

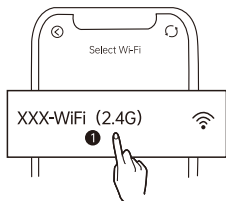

(2) "Connection successful" will be displayed when connecting successfully, then return to APP home page.

### 3. Print

- (1) Open the SoPrint APP;
- (2) Select the content that needs to be printed by "Print image" or "Print file" from the home menu, set it to image format, then click the print.

 **Note:** Please refer to the latest version APP.

 **Note:** The edge of paper tearing blade is sharp, please be careful not to get scratched.

 **Warning:** During the printing or just finished printing, the print head will heat up, do not touch the print head and surrounding parts. Children must use it under adult supervision.

 **Warning:** Do not touch the thermal print head surface and connector. Avoid electrostatic damage to the print head.

## Print via computer connection

### Connect the printer

- 1 Turn on the printer (long press the power button for 3 seconds to turn on the printer);
- 2 Connect the computer and printer by USB cable.

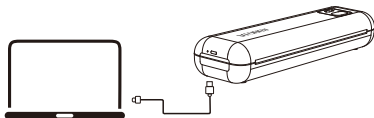

### Mounting driver

- 1 Download the latest version driver from [rongtatech.com/f82](http://rongtatech.com/f82)
- 2 After entering the website, find the corresponding model driver, download and install it.









1. There is a risk of explosion if you change the battery pack with an incorrect model;
2. Please do not put the battery into the fire or heating furnace, do not mechanically squeeze or cut the battery for disposal;
3. Do not place the battery in an extremely high temperature environment that may cause the battery to explode or leak flammable liquids or gases;
4. Do not place the battery in an extremely low pressure that may cause the battery to explode or leak flammable liquids and gases.





# Button and display

## Button operation instruction

Button	Function
Power button	1. Press and hold 3s to power on/off 2. Double-click to print the self-test page and learn the paper (Continuous paper, label paper, black label paper, etc.)
Reset button	Pinhole reset mode

## Display identification description

Display status	Status description
	Power-on
	OTA upgrade
	Bluetooth connection and time
	Low battery warning
	Battery charging
	Paper Type Error

Display status	Status description
	Overtemperature warning
	Paper ready
	Printing
	Print Complete
	Open Error

## FCC Warning

This device complies with part 15 of the FCC Rules. Operation is subject to the following two conditions: (1) This device may not cause harmful interference, and (2) this device must accept any interference received, including interference that may cause undesired operation.

Note: This equipment has been tested and found to comply with the limits for a Class B digital device, pursuant to part 15 of the FCC Rules. These limits are designed to provide reasonable protection against harmful interference in a residential installation.

This equipment generates, uses and can radiate radio frequency energy and, if not installed and used in accordance with the instructions, may cause harmful interference to radio communications. However, there is no guarantee that interference will not occur in a particular installation. If this equipment does cause harmful interference to radio or television reception, which can be determined by turning the equipment off and on, the user is encouraged to try to correct the interference by one or more of the following measures:

- Reorient or relocate the receiving antenna.
- Increase the separation between the equipment and receiver.
- Connect the equipment into an outlet on a circuit different from that to which the receiver is connected.
- Consult the dealer or an experienced radio/TV technician for help.

Note: The Grantee is not responsible for any changes or modifications not expressly approved by the party responsible for compliance. Such modifications could void the user's authority to operate the equipment.

The device has been evaluated to meet general RF exposure requirement. The SAR limit of USA(FCC) is 1.6 W/kg averaged over one gram of tissue. Device types A4 Portable Printer with F82 (FCC ID: 2AD6G-F82) have also been tested against this SAR limit. The highest reported SAR values for body-worn is 0.974W/kg. This device was tested for typical body-worn operations with the back of the handset kept 0mm from the body. The use of accessories that do not satisfy these requirements may not comply with FCC RF exposure requirements, and should be avoided.



### **Rongta Technology (Xiamen) Group Co., Ltd.**

ADD: No.88, Tonghui South Road, Tongan, Xiamen, China.

Email: [support@rongtatech.com](mailto:support@rongtatech.com)

WEB: [www.rongtatech.com](http://www.rongtatech.com)